

## Shouldered Blank End

**minsop**



Size NB	Size (inch)	Part No.	ØD (mm)	W (mm)	WP		Price \$
					PSI	MPa	
50	2	08/048/03/000	66.5	16.0	750	5.1	26.39
80	3	08/048/03/002	97.0	16.0	750	5.1	47.49
100	4	08/048/03/003	122.0	17.5	580	4.0	51.54
150	6	08/048/03/005	174.5	17.5	750	5.1	68.62
150 USA	6 USA	08/048/03/658	178.0	17.5	580	4.0	77.25
200	8	08/048/03/006	i 232.0	20.5	580	4.0	564.84

Price Group: SD

AE01

## Shouldered Blank End with Female BSP Outlet

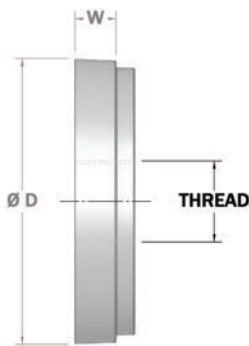

Size NB	Thread BSP (inch)	Part No.	ØD (mm)	W (mm)	WP		Price \$
					PSI	MPa	
50	1	08/048/04/000	66.5	16.0	750	5.1	39.92
80	1	08/048/04/003	97.0	16.0	750	5.1	55.22
100	1	08/048/04/006	122.0	17.5	750	5.1	64.18
150	1	08/048/04/015	174.5	17.5	580	4.0	89.71
80	2	08/048/04/004	97.0	16.0	750	5.1	70.84
100	2	08/048/04/007	122.0	17.5	750	5.1	65.14
150	2	08/048/04/016	i 174.5	17.5	580	4.0	81.29
100	3	08/048/04/009	122.0	17.5	750	5.1	111.24
150	3	08/048/04/018	174.5	17.5	580	4.0	136.67

Price Group: SD

AE01

## Shoulder Ring

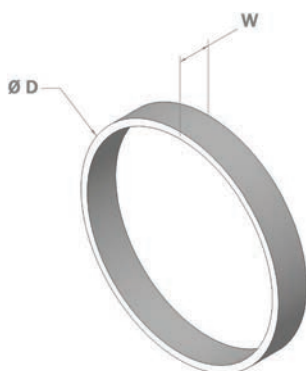

Size NB	Part No.	Pipe OD (mm)	ØD (mm)	W (mm)	Price \$
50	08/048/18/000	60.3	66.5	16.0	6.80
80	08/048/18/002	88.9	97.0	16.0	6.13
100	08/048/18/003	114.3	122.0	17.5	7.47
150	08/048/18/005	165.1	174.5	17.5	10.82
150 USA	08/048/18/658	i 168.3	178.0	17.5	72.10
200	08/048/18/006	219.1	232.0	20.5	20.60
Split					
250	08/048/18/007	273.0	286.0	20.5	63.86
300	08/048/18/008	323.9	336.5	20.5	65.92
350	08/048/18/009	355.6	368.5	24.0	145.20
400	08/048/18/010	406.4	419.0	25.5	196.60
450	08/048/18/021	457.0	470.0	25.5	216.02
500	08/048/18/023	508.0	520.5	25.5	221.45
600	08/048/18/024	i 610.0	622.5	25.5	236.90

Price Group: SD

AE02

U

504 - 538