

ANFO Loader Spare Parts Sub Assemblies

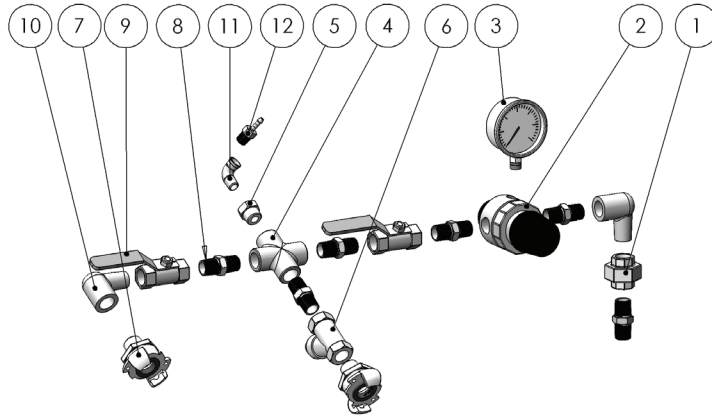

100Kg, 200Kg, 250Kg AND 500Kg CONFIGURATIONS (REMOTE CONTROL VERSION)

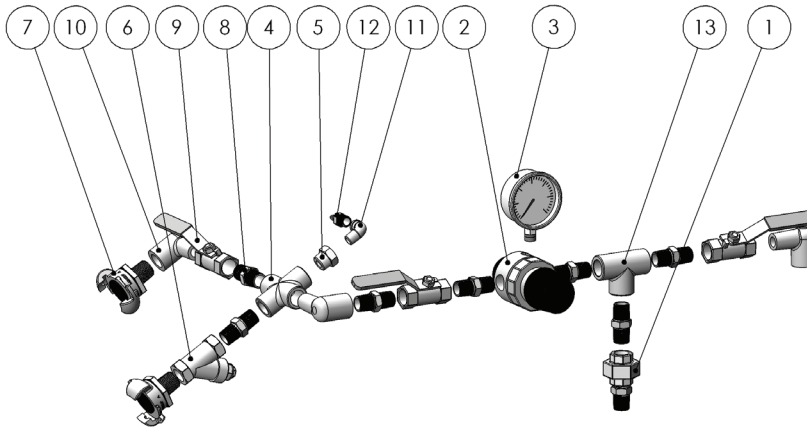

45Kg CONFIGURATION (REMOTE CONTROL VERSION)

MANIFOLD ASSEMBLY

Minsup™ manifold assemblies are constructed from Stainless Steel components ideally suitable in preventing the formation of tetra-ammine copper nitrate (TACN)

Part No.	Description	Price \$ (ea)
08/040/01/082R	Manifold Assembly to suit remote op.	3995.28
08/040/01/082	Manifold Assembly. to suit manual op.	3324.40

Price Group: SD

Ref No.	Part No.	Description	Price \$ (ea)
1	SS16UMF015	Union ½" BSP M/F S/S	30.22
2	05/040/01/014SS	Regulator ½" BSP S/S	2220.91
3	05/040/01/015SS	Gauge ¼" BSP 0-1000 PSI	282.01
4	SS16CR015	Cross " BSP S/S	35.31
5	SS16B1508	Red. Bush ½" x ¼" BSP S/S	5.85
6	08/001/09/000	½" 'A' Type Male BSP	13.38
7	SYS-015	Strainer Y ½" BSP S/S	43.11
8	SS16HN015	Nipple ½" BSP S/S	6.14
9	SS1P012	15mm 1 Piece S/S Ball Valve	24.23
10	SS16ELMF015	Elbow ½" BSP M/F S/S	8.60
11 ¹	SS16ELMF008	Elbow ¼" BSP M/F S/S	4.91
12 ¹	08/040/08/082SS	Tail Hose 3/16" x ¼" BSP S/S	9.56
13	SS16T015	Tee ½" BSP S/S	10.28
²	SS16XP008	Hex Plug ¼" BSP S/S	1.97

¹ used in 08/040/01/082R only

² used in 08/040/01/082 only in replacement of 11 & 12

Price Group: SD

AG04

