

Minsup™ Shouldered Butterfly Valves

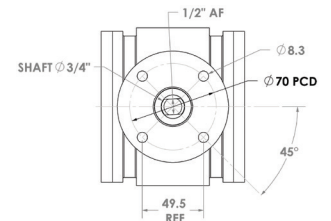

Design:	Lever operated, corrosion resistant stainless steel disk and shaft. Lever can be padlocked out in any of 11 positions. Nitrile Butadiene lining is moulded to the body. Disc has high flow coefficient design which minimizes flow resistance and cavitation.
End Connection:	Shouldered
Body Materials:	Body - SG Iron to ISO 1083; 400-250-15 Lining - Nitrile Butadiene - 70 Duro hardness Disc - Cast SS Grade CF8M to ASTM A351 Handle - SG Iron ISO 1083;400-250-15 Shaft - Grade 316 Stainless Steel
Seats & Trim:	Nitrile Butadiene lining
Actuator:	Lever as standard
Temperature:	Min -20°C Max 60°C
Pressure:	Water: 2000 kPa, 290 PSI Air: 1034 kPa, 150 PSI
Standards:	Shouldered ends in accordance with ANSI/AWWA C606 Actuator mounting flange in accordance with AS5211
Options:	Actuation available on request. Optional operators include manual gearbox and pneumatic actuator.
Application:	Mining Industry



Lever Operated			
Size NB (mm)	Part No.	Face to Face Dimensions (mm)	Price \$
100	08/002/374/00	116	611.24
150	08/002/574/00	149	1082.27

Price Group: MS
AB02

Mounting pads are the same on 4" and 6" Minsup™ valves.
Handles and actuators will interchange between 4" and 6" Minsup™ valves.

316 Stainless Steel Wafer & Lugged Butterfly Valves

Design:	Butterfly valve, wafer and fully lugged, lever operated
End Connection:	Wafer Type fits between Table E, Lugged valve is to AS2129 table E
Body Materials:	Stainless Steel 316 (CF8M)
Seats & Trim:	Stem: SS316, Seat: PTFE (Epdm encapsulated)
Pressure:	PN10 or 1000KPA
Application:	Petro - Chemical, Oil & Gas, Marine, & Industrial applications
Options:	Lugged ANSI Class 150 available on request.
Accessories:	Gear Operators , Pneumatic & Electric Actuators
Features:	ISO top for direct mounting of actuators & SS lever & Notch plate



Wafer

M



Lugged

Size NB (inch)	Size NB (mm)	Wafer Table E		Lugged Table E	
		Part No.	Price \$	Part No.	Price \$
1 1/2	40	BFVW-SS-040	629.69	---	---
2"	50	BFVW-SS-050	629.69	BFVL-SS-050	779.45
2 1/2	65	BFVW-SS-065	740.51	BFVL-SS-065	923.52
3	80	BFVW-SS-080	841.26	BFVL-SS-080	1017.58
4	100	BFVW-SS-100	1057.88	BFVL-SS-100	1478.30
6	150	BFVW-SS-150	1894.10	BFVL-SS-150	2281.13
8	200	BFVW-SS-200	3093.03	BFVL-SS-200	3722.71

Price Group: SD
VS02

