

Shouldered Blank Ends

minsup

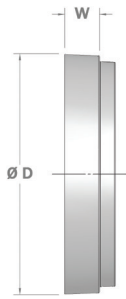

Size NB	Size (inch)	Part No.	ØD (mm)	W (mm)	WP		Price \$
					PSI	MPa	
50	2	08/048/03/000	66.5	16.0	750	5.1	30.57
80	3	08/048/03/002	97.0	16.0	750	5.1	55.02
100	4	08/048/03/003	122.0	17.5	580	4.0	59.71
150	6	08/048/03/005	174.5	17.5	750	5.1	79.50
200	8	08/048/03/006	232.0	20.5	580	4.0	278.07

Price Group: SD
AE01

Shouldered Blank Ends with Female BSP Outlet

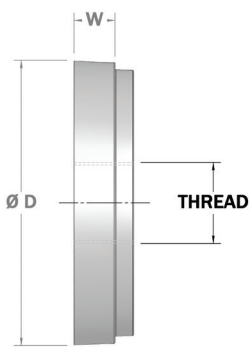

Size NB	Thread BSP (inch)	Part No.	ØD (mm)	W (mm)	WP		Price \$
					PSI	MPa	
50	1	08/048/04/000	66.5	16.0	750	5.1	46.25
80	1	08/048/04/003	97.0	16.0	750	5.1	63.98
100	1	08/048/04/006	122.0	17.5	750	5.1	74.36
150	1	08/048/04/015	174.5	17.5	580	4.0	103.94
80	2	08/048/04/004	97.0	16.0	750	5.1	82.07
100	2	08/048/04/007	122.0	17.5	750	5.1	75.47
150	2	08/048/04/016	174.5	17.5	580	4.0	94.18
100	3	08/048/04/009	122.0	17.5	750	5.1	128.89
150	3	08/048/04/018	174.5	17.5	580	4.0	158.35

Price Group: SD
AE01

Shoulder Rings

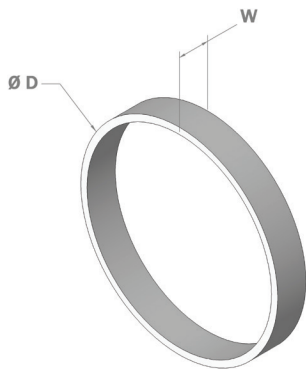

Size NB	Part No.	Pipe OD (mm)	ØD (mm)	W (mm)	Price \$
50	08/048/18/000	60.3	66.5	16.0	7.88
80	08/048/18/002	88.9	97.0	16.0	7.10
100	08/048/18/003	114.3	122.0	17.5	8.65
150	08/048/18/005	165.1	174.5	17.5	12.54
150 USA	08/048/18/658	168.3	178.0	17.5	21.38
200	08/048/18/006	219.1	232.0	20.5	23.87
Split					
250	08/048/18/007	273.0	286.0	20.5	73.99
300	08/048/18/008	323.9	336.5	20.5	76.38
350	08/048/18/009	355.6	368.5	24.0	120.38
400	08/048/18/010	406.4	419.0	25.5	227.78
450	08/048/18/021	457.0	470.0	25.5	250.29
500	08/048/18/023	508.0	520.5	25.5	256.58
600	08/048/18/024	610.0	622.5	25.5	274.48

Price Group: SD
AE02