

E-Series Straight-Through Couplers

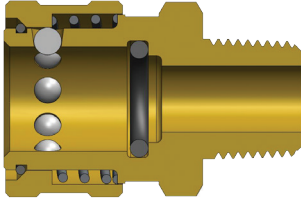

Male Thread



Size (inch)	Part No.	Thread Size (inch)	Body Material	Weight (kg)	Pkg Qty		Price \$ (ea)
					Bag	Box	
1/8	1EM1-B	1/8 - 27 NPTF	Brass	0.03	250	500	9.10
1/8	1EM1-S	1/8 - 27 NPTF	303 SS	0.02	250	500	30.50
1/4	2EM2-B	1/4 - 18 NPTF	Brass	0.08	50	200	11.47
3/8	3EM3-B	3/8 - 18 NPTF	Brass	0.12	50	200	19.45
3/8	3EM3-S	3/8 - 18 NPTF	303 SS	0.11	50	200	31.50
1/2	4EM4-B	1/2 - 14 NPTF	Brass	0.18	25	100	25.11
1/2	4EM4-S	1/2 - 14 NPTF	303 SS	0.16	25	100	46.01
3/4	6EM6-B	3/4 - 14 NPTF	Brass	0.28	15	60	48.98
3/4	6EM6-S	3/4 - 14 NPTF	303 SS	0.26	15	60	69.41
1	8EM8-B	1 - 11 1/2 NPTF	Brass	0.45	15	30	68.35
1	8EM8-S	1 - 11 1/2 NPTF	303 SS	0.42	15	30	75.27
1 1/4	10EM10-B	1 1/4 - 11 1/2 NPTF	Brass	0.74	-	10	132.80
1 1/2	12EM12-B	1 1/2 - 11 1/2 NPTF	Brass	0.93	-	5	253.76
2	16EM16-B	2 - 11 1/2 NPTF	Brass	1.43	-	1	323.98

Price Group: PC
AP01

E-Series Straight-Through Nipples

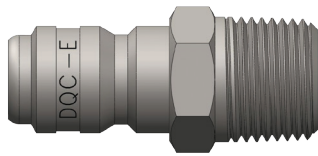

Male Thread

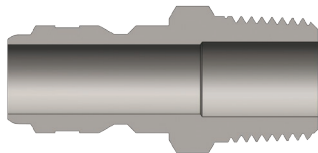

Size (inch)	Part No.	Thread Size (inch)	Body Material	Weight (kg)	Pkg Qty		Price \$ (ea)
					Bag	Box	
1/8	E1M1	1/8 - 27 NPTF	Steel	0.01	250	500	2.26
1/8	E1M1-B	1/8 - 27 NPTF	Brass	0.01	250	500	2.28
1/8	E1M1-S	1/8 - 27 NPTF	303 SS	0.01	250	500	12.18
1/4	E2M2	1/4 - 18 NPTF	Steel	0.02	50	200	3.42
1/4	E2M2-B	1/4 - 18 NPTF	Brass	0.03	50	200	3.62
1/4	E2M2-S	1/4 - 18 NPTF	303 SS	0.02	50	200	10.66
3/8	E3M3	3/8 - 18 NPTF	Steel	0.03	50	200	5.57
3/8	E3M3-B	3/8 - 18 NPTF	Brass	0.04	50	200	6.53
3/8	E3M3-S	3/8 - 18 NPTF	303 SS	0.04	50	200	14.99
1/2	E4M4	1/2 - 14 NPTF	Steel	0.06	35	140	7.15
1/2	E4M4-B	1/2 - 14 NPTF	Brass	0.07	35	140	8.22
1/2	E4M4-S	1/2 - 14 NPTF	303 SS	0.06	35	140	17.15
3/4	E6M6	3/4 - 14 NPTF	Steel	0.09	25	100	10.69
3/4	E6M6-B	3/4 - 14 NPTF	Brass	0.10	25	100	19.50
3/4	E6M6-S	3/4 - 14 NPTF	303 SS	0.10	25	100	24.51
1	E8M8	1 - 11 1/2 NPTF	Steel	0.20	25	50	35.07
1	E8M8-B	1 - 11 1/2 NPTF	Brass	0.22	25	50	36.03
1	E8M8-S	1 - 11 1/2 NPTF	303 SS	0.20	25	50	46.55
1 1/4	E10M10	1 1/4 - 11 1/2 NPTF	Steel	0.43	-	10	59.72
1 1/4	E10M10-B	1 1/4 - 11 1/2 NPTF	Brass	0.43	-	10	83.06
1 1/2	E12M12	1 1/2 - 11 1/2 NPTF	Steel	0.66	-	5	87.13
1 1/2	E12M12-B	1 1/2 - 11 1/2 NPTF	Brass	0.66	-	5	89.47
2	E16M16	2 - 11 1/2 NPTF	Steel	0.70	-	1	192.19
2	E16M16-B	2 - 11 1/2 NPTF	Brass	0.68	-	1	150.20

Price Group: PC
AP01

FOR TECHNICAL GUIDELINES PLEASE REFER TO PAGE 317



1300 134 651
dixonvalve.com.au

All prices exclude GST.
ADPL718