

N-Series Dix-Lock™ Nipple

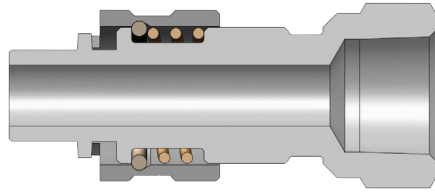

Female Thread



N-Series Bowes Interchange Nipple

Body Size (inch)	Part No.	Threads (inch)	Material	Length		Maximum OD		Hex Size (inch)	Weight (kg)	Pkg Qty		Price \$ (ea)
				inch	mm	inch	mm			Bag	Box	
½	N4F3	¾ - 18 NPTF	Steel	2.73	69.3	1.40	35.6	1½	0.22	-	25	56.93
½	N4F3-B	¾ - 18 NPTF	Brass	2.73	69.3	1.40	35.6	1½	0.24	-	25	69.91
½	N4BF3	¾ - 19 BSPPF	Steel	2.73	69.3	1.40	35.6	1½	0.22	-	25	50.28
½	N4F4	½ - 14 NPTF	Steel	2.73	69.3	1.40	35.6	1½	0.34	-	25	35.28
½	N4F4-B	½ - 14 NPTF	Brass	2.73	69.3	1.40	35.6	1½	0.38	-	25	93.05
½	N4BF4	½ - 14 BSPPF	Steel	2.73	69.3	1.40	35.6	1½	0.34	-	25	73.37
½	N4BF4-B	½ - 14 BSPPF	Brass	2.73	69.3	1.40	35.6	1½	0.38	-	25	80.34
½	N4F6	¾ - 14 NPTF	Steel	3.34	84.8	1.58	40.1	1½	0.30	-	25	48.12
½	N4F6-B	¾ - 14 NPTF	Brass	3.34	84.8	1.58	40.1	1½	0.34	-	25	68.38
½	N4F6-S	¾ - 14 NPTF	303 SS	3.34	84.8	1.58	40.1	1½	0.31	-	25	197.54
½	N4BF6	¾ - 14 BSPPF	Steel	3.34	84.8	1.58	40.1	1½	0.32	-	25	68.10
½	N4BF6-B	¾ - 14 BSPPF	Brass	3.34	84.8	1.58	40.1	1½	0.34	-	25	79.80
½	N4F8	1 - 11 ½ NPTF	Steel	3.37	85.7	1.73	43.9	1½	0.33	-	25	68.97
½	N4F8-B	1 - 11 ½ NPTF	Brass	3.37	85.7	1.73	43.9	1½	0.35	-	25	106.16
½	N4BF8	1 - 11 BSPPF	Steel	3.37	85.7	1.73	43.9	1½	0.33	-	25	81.08
½	N4BF8-B	1 - 11 BSPPF	Brass	3.37	85.7	1.73	43.9	1½	0.35	-	25	116.50

Price Group: PC

AD07

N-Series Dix-Lock™ Safety-Lock Nipple

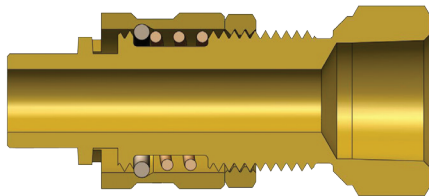

Female Thread



N-Series Bowes Interchange Safety-Lock Nipple

Body Size (inch)	Part No.	Threads (inch)	Material	Length		Maximum OD		Hex Size (inch)	Weight (kg)	Pkg Qty		Price \$ (ea)
				inch	mm	inch	mm			Bag	Box	
½	N4F4-B-LS	½ - 14 NPTF	Brass	4.28	108.6	1.58	40.1	1½	0.31	-	25	59.39
½	N4F6-B-LS	¾ - 14 NPTF	Brass	4.38	111.2	1.73	43.9	1½	0.30	-	25	99.30

Price Group: PC

AD07

FOR TECHNICAL GUIDELINES PLEASE REFER TO PAGE 249

