



Hygienic Valves & Pumps Catalogue

Uncommon Excellence

Hygienic Valves & Pumps 3

B5107 Series Butterfly Valves.....	3
B5107 Series Butterfly Valves - Pull Handle.....	3
B5107 Series Butterfly Valves - Trigger Handle.....	5
Vertical Spring Return Actuation Butterfly Valves	7
B5107 Butterfly Valve Part Number Key.....	9
B5107 Butterfly Valve Part Number Key.....	10
HSC Series Spring Check Valves	11
Ball Valves - Encapsulated	12
BV3/4 Series Multi-Port Sanitary Stainless Steel Ball Valves.....	12
BV3/4 Series Multi-Port Sanitary Stainless Steel Ball Valves.....	13
Air & Vacuum Relief Tank Vent Valve	14
Air & Vacuum Relief Tank Vent Valve - Stainless Steel.....	14
Dixon™/Rieger Aseptic Type Valves	15
Dixon™/Rieger Aseptic Type Valves	15
SSV Series Single Seat Hygienic Valves	16
Positioner Type 8692 & 8694 - For Pneumatic Control	
Angle Valves.....	16
SSV Single Seat Valve Part Number Key	17
Dixon™/Rieger Mix Proof Valves	18
Valve Body Types	18
Dixon™/Rieger Control Valves & In Aseptic Version.....	19
Mini Aseptic Sampling Valve.....	20
BioCheck Combi Sampling Valves with Steam Valve.....	20
BSV Series 3A Sample Valves	21
Dixon™/Rieger Safety Valves	22
SOV Series Manual & Pneumatic Overflow Valve.....	22
SPR Series Pressure Relief Valves.....	23
JZW Series Heli-Lobe Wine Pump.....	23
RZL Series Rotary Lobe Pumps	24
Heli-Lobe Rotors.....	24
RZL Series Rotary Lobe Pump Options	25
RZP Series Circumferential Piston Pumps	26
ExD Series Sanitary Centrifugal Pumps	26
JCP Series Centrifugal Pumps.....	27
BC Series Centrifugal Pumps	27
JWP Series - Water for Injection	28
JEPS Series Self-Priming Centrifugal Pump.....	28
JSB Series Shear Blender	29

B5107 Series Butterfly Valves

Application

- Hygienic shut-off valve for use in stainless steel tube systems on tanks and general food and beverage processing. For use on low to medium-viscosity liquids, as well as food, beverage, wine, brewery, and personal care.

Features

- 100% hydraulic tested/100% inspected
- All wetted surfaces are sanitary finished to 32Ra
- Field serviceable (no special tools required)

Materials

Construction

- Product contact components, body, and disc: forged 316L
- Non-product contact components: 304

Sealing

- Product contact component, seals: EPDM, FKM, silicone
- Non-product contact components, bushings: Polyacetal

Connections

- Tube weld (standard)
- Other end connections on request: Weld end, female I-Line, male I-Line, threaded bevel, plain bevel, Q-Line, John Perry threaded

Product Operating Temperature

- Maximum: 93°C
- Minimum: -9°C

Minimum Line Pressure

- 0.4 inches Hg vacuum at 20°C

Surface Finish

- Product contact components: Ra ≤ 0.8
- Optional finishes: 0.38µm (15Ra), 0.58µm (20Ra), 0.635µm (25Ra)

Valve Stem Size

- ½" to 4" - 10mm
- 6" - 13mm
- 8" - 14mm

Based on Water at 20°C

Valve Size		Break Torque (in-Nm)			Pressure Rating		Flow Coefficient (Cv)
mm	inch	Silicone	EPDM	FKM	PSI	kPa	
12	½	2	1.5	8	140	965	7
20	¾	2	1.5	8	140	965	11
25	1	3	1.5	8	140	965	23
38	1½	4	2	14	140	965	80
50	2	4	5.5	20	140	965	230
65	2½	15	11	25	110	758	264
80	3	15	16.5	35	110	758	372
100	4	30	39	51	85	586	800
150	6	87.5	94	n/a	60	413	1200
200	8	125	125	n/a	60	413	2800

B5107 Series Butterfly Valves - Pull Handle



Weld End

Size		Part Numbers		
mm	inch	EPDM	Silicone	FKM
12	½	B5107E050BB-A	B5107S050BB-A	B5107V050BB-A
20	¾	B5107E075BB-A	B5107S075BB-A	B5107V075BB-A
25	1	B5107E100BB-A	B5107S100BB-A	B5107V100BB-A
38	1½	B5107E150BB-A	B5107S150BB-A	B5107V150BB-A
50	2	B5107E200BB-A	B5107S200BB-A	B5107V200BB-A
65	2½	B5107E250BB-A	B5107S250BB-A	B5107V250BB-A
80	3	B5107E300BB-A	B5107S300BB-A	B5107V300BB-A
100	4	B5107E400BB-A	B5107S400BB-A	B5107V400BB-A
150	6	B5107E600BB-A	B5107S600BB-A	B5107V600BB-A
200	8	B5107E800BB-A	B5107S800BB-A	B5107V800BB-A

Product Group: VF09

B5107-Series Butterfly Valve

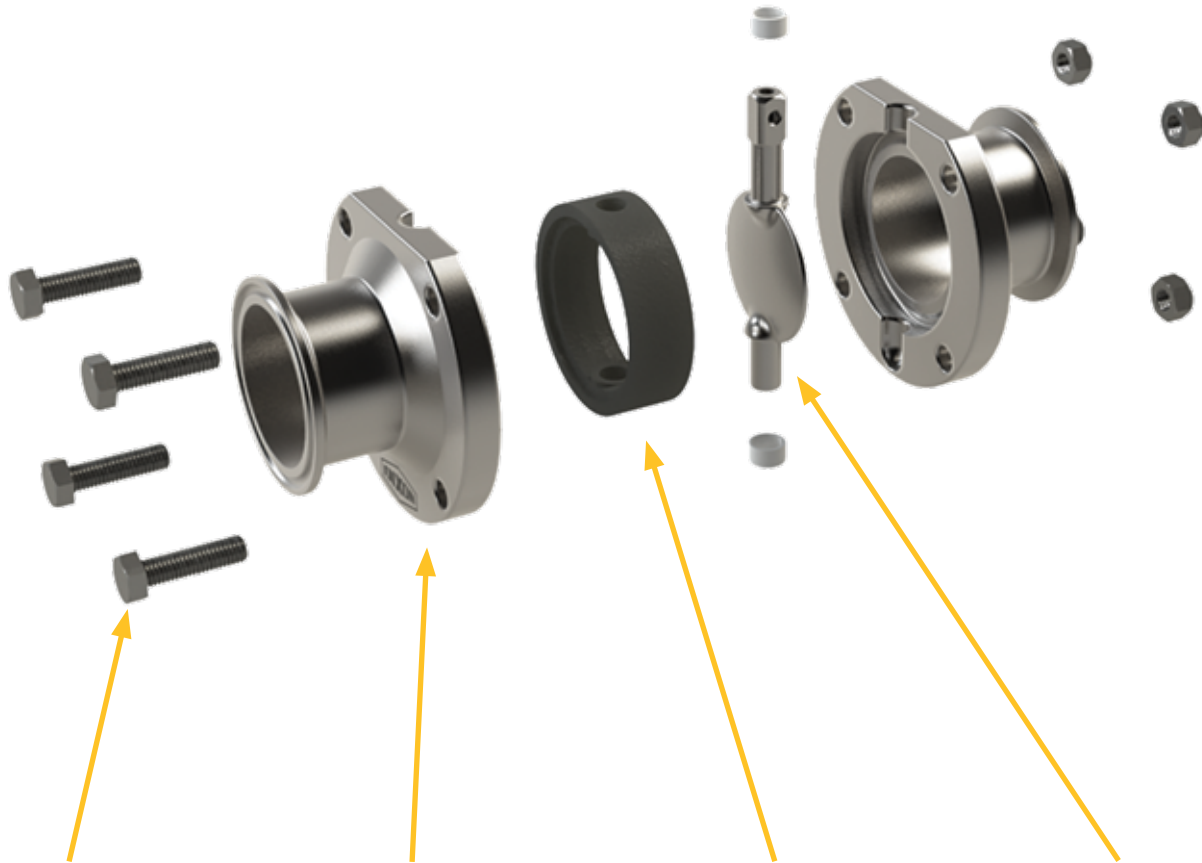

Hex Head Body Bolts

Hex head body bolts eliminate the recessed cavity found in socket head body bolts, reducing the potential for bacterial buildup. Sizes 1/2" to 4"

Exterior Body Geometry

Body design enhances the exterior cleanability and drainability of the valve by utilizing a large machined chamfer between the flange face and the tube OD

Seal Performance

Our new EPDM with self-lubricating properties and silicone rubber help to reduce break torque and provide added durability to valve seats. Silicone and EPDM for valve sizes 1/2" to 4" have USP VI certification

Valve Disc

Increased disc stem square size provides added durability when higher torques are experienced due to viscous or sticky process fluids



Clamp End

Size		Part Numbers		
mm	inch	EPDM	Silicone	FKM
12	½	B5107E050CC-A	B5107S050CC-A	B5107V050CC-A
20	¾	B5107E075CC-A	B5107S075CC-A	B5107V075CC-A
25	1	B5107E100CC-A	B5107S100CC-A	B5107V100CC-A
38	1½	B5107E150CC-A	B5107S150CC-A	B5107V150CC-A
50	2	B5107E200CC-A	B5107S200CC-A	B5107V200CC-A
65	2½	B5107E250CC-A	B5107S250CC-A	B5107V250CC-A
80	3	B5107E300CC-A	B5107S300CC-A	B5107V300CC-A
100	4	B5107E400CC-A	B5107S400CC-A	B5107V400CC-A
150	6	B5107E600CC-A	B5107S600CC-A	B5107V600CC-A
200	8	B5107E800CC-A	B5107S800CC-A	B5107V800CC-A

Product Group: VF09

B5107 Series Butterfly Valves - Trigger Handle

Weld End



Size		Part Numbers		
mm	inch	EPDM	Silicone	FKM
12	½	B5107E050BB-C	B5107S050BB-C	B5107V050BB-C
20	¾	B5107E075BB-C	B5107S075BB-C	B5107V075BB-C
25	1	B5107E100BB-C	B5107S100BB-C	B5107V100BB-C
38	1½	B5107E150BB-C	B5107S150BB-C	B5107V150BB-C
50	2	B5107E200BB-C	B5107S200BB-C	B5107V200BB-C
65	2½	B5107E250BB-C	B5107S250BB-C	B5107V250BB-C
80	3	B5107E300BB-C	B5107S300BB-C	B5107V300BB-C
100	4	B5107E400BB-C	B5107S400BB-C	B5107V400BB-C
150	6	B5107E600BB-C	B5107S600BB-C	B5107V600BB-C
200	8	B5107E800BB-C	B5107S800BB-C	B5107V800BB-C

Product Group: VF09

Clamp End



Size		Part Numbers		
mm	inch	EPDM	Silicone	FKM
12	½	B5107E050CC-C	B5107S050CC-C	B5107V050CC-C
20	¾	B5107E075CC-C	B5107S075CC-C	B5107V075CC-C
25	1	B5107E100CC-C	B5107S100CC-C	B5107V100CC-C
38	1½	B5107E150CC-C	B5107S150CC-C	B5107V150CC-C
50	2	B5107E200CC-C	B5107S200CC-C	B5107V200CC-C
65	2½	B5107E250CC-C	B5107S250CC-C	B5107V250CC-C
80	3	B5107E300CC-C	B5107S300CC-C	B5107V300CC-C
100	4	B5107E400CC-C	B5107S400CC-C	B5107V400CC-C
150	6	B5107E600CC-C	B5107S600CC-C	B5107V600CC-C
200	8	B5107E800CC-C	B5107S800CC-C	B5107V800CC-C

Product Group: VF09

B5107-Series Butterfly Valve



Actuation Coupler

Coupler design eliminates the need for the roll pin to connect to the actuator, saving time during assembly. Additionally, sensing targets are incorporated into the coupler meaning no extra accessories are needed when adding external proximity sensors

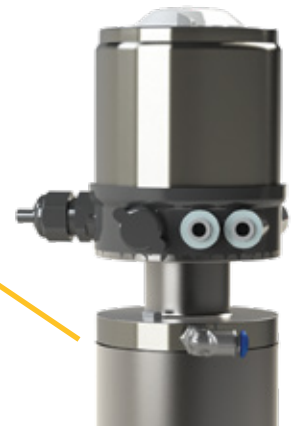

Control Top Ready Actuator

Actuator design allows for a control top to be added to any standard actuator in the field without the need to change the actuator



Single Piece Actuator Bracket

Single piece bracket makes assembly fast and easy compared to two-piece designs



Prox-Ready Mounting Holes

Sensors can easily be added to any actuated valve without the need to purchase additional mounting hardware

Vertical Spring Return Actuation Butterfly Valves Stainless Steel

Application

- "Automatic" shut-off valve for use in stainless steel tube systems on tanks and in general food and beverage processing. Suitable for use with low to medium-viscosity liquids, as well as with food, beverage, wine, brewery, and personal care products.



Weld End

Size		EPDM Seats & Vertical Canister Style Actuator - Butt Weld		
mm	inch	EPDM Seats Normally Closed	EPDM Seats Normally Open	EPDM Seats Double Acting
25	1	B5107E100BBG	B5107E100BBF	B5107E100BBH
38	1½	B5107E150BBG	B5107E150BBF	B5107E150BBH
50	2	B5107E200BBG	B5107E200BBF	B5107E200BBH
65	2½	B5107E250BBG	B5107E250BBF	B5107E250BBH
80	3	B5107E300BBG	B5107E300BBF	B5107E300BBH
100	4	B5107E400BBG	B5107E400BBF	B5107E400BBH

Also available in silicon and FKM

Product Group: VF09



Clamp End

Size		EPDM Seats & Vertical Canister Style Actuator - Butt Weld		
mm	inch	EPDM Seats Normally Closed	EPDM Seats Normally Open	EPDM Seats Double Acting
25	1	B5107E100CCG	B5107E100CCF	B5107E100CCH
38	1½	B5107E150CCG	B5107E150CCF	B5107E150CCH
50	2	B5107E200CCG	B5107E200CCF	B5107E200CCH
65	2½	B5107E250CCG	B5107E250CCF	B5107E250CCH
80	3	B5107E300CCG	B5107E300CCF	B5107E300CCH
100	4	B5107E400CCG	B5107E400CCF	B5107E400CCH

Also available in silicon and FKM

Product Group: VF09



Actuator Specifications

	Double Acting	Spring Return
Down Stroke CW	139	139
Up Stroke CCW	328	303
Max. Temperature	121°C	121°C
Min. Temperature	-20°C	-20°C
Output Torque (Nm)	65.14	65.14
Max Pressure (PSI)	120	120
Supply Pressure (PSI)	80-100	80-100
Diameter (mm)	86	86
Height (mm)	149	149
Air Fitting Ports (inch)	1/8 NPT	1/8 NPT

Mounting Kits

Size		Part Numbers	
mm	inch	Double Acting	Spring Return
12 - 38	½ - 1½	VC1DA-7-5015	VC1SR-7-5015
50 - 65	2 - 2½	VC1DA-7-2025	VC1SR-7-2025
80 - 100	3 - 4	VC1DA-1-7-3040	VC1SR-1-7-3040

Product Group: VF09



B5107 Seat Dimensions

Size		A (mm)	B (mm)	C (mm)	D (mm)
mm	inch				
12 - 25	½ - 1	36.06	21.08	9.40	19.56
38	1½	49.02	34.04	9.40	19.56
50	2	65.02	43.94	9.40	19.81
65	2½	76.96	59.69	11.68	23.11
80	3	92.96	71.12	13.97	27.94
100	4	125.98	98.04	15.75	36.32
150	6	173.48	147.07	15.75	43.18
200	8	236.73	200.41	17.02	40.39

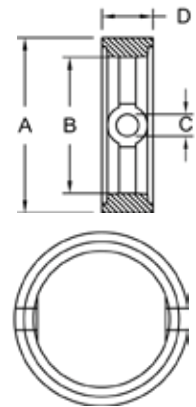

Repair Kits - USP Class VI Certified

Size		Part Numbers		
mm	inch	Black EPDM	Red Silicone	Brown FKM
25	1	B5107-RKE100	B5107-RKS100	B5107-RKV100
38	1½	B5107-RKE150	B5107-RKS150	B5107-RKV150
50	2	B5107-RKE200	B5107-RKS200	B5107-RKV200
65	2½	B5107-RKE250	B5107-RKS250	B5107-RKV250
80	3	B5107-RKE300	B5107-RKS300	B5107-RKV300
100	4	B5107-RKE400	B5107-RKS400	B5107-RKV400
150	6	B5107-RKE600	B5107-RKS600	B5107-RKV600
200	8	B5107-RKE800	-	B5107-RKV800

For B5107 series valves, also compatible with B5101 series valves

Product Group: VF09



B5107 Butterfly Valve Part Number Key

Dixon B5107 Butterfly Valve Part Number Key Example: B5107E050CC-A		Series	Seat Material	Valve Size	Connection End	Connection End	Actuator
		B5107	E	050	C	C	-A
Series	Code						
Two-piece body	B5107						
Seat Material	Code						
EPDM	E						
Silicone	S						
FKM	V						
Valve size	Code						
1/2"	050						
3/4"	075						
1"	100						
1-1/2"	150						
2"	200						
2-1/2"	250						
3"	300						
4"	400						
6"	600						
8"	800						
Connections (choose connection for each side of valve)	Code						
Clamp	C						
Weld	B						
Female I-Line	F						
Male I-Line	M						
Threaded bevel	T						
Plain bevel	P						
Q-Line	Q						
Actuation	Code						
*Manual handle - 4 position standard handle	A						
*Manual handle - infinite position handle	B						
*Manual handle - 13 position trigger handle	C						
24VDC electric (power open/power close)	D						
110VAC electric (power open/power close)	E						
Normally open linear pneumatic vertical canister (cannot be used on valves over 4")	F						
Normally closed linear pneumatic vertical canister (cannot be used on valves over 4")	G						
Air to air linear pneumatic vertical canister (cannot be used on valves over 4")	H						
Air to air pneumatic rack and pinion stainless steel	J						
Normally closed pneumatic rack and pinion stainless steel	K						
Normally open pneumatic rack and pinion stainless steel	L						
Air to air pneumatic rack and pinion aluminium	M						
Normally closed pneumatic rack and pinion aluminium	N						
Normally open pneumatic rack and pinion aluminium	P						
Normally closed, dead man handle	Q						
220VAC electric (power open/power close)	R						

*NOTE: Only use a dash (-) in the part number if using a manual handle with no options, otherwise the dash is eliminated.

B5107 Butterfly Valve Part Number Key

Dixon B5107 Butterfly Valve Part Number Key (continued)		Control Unit/ Feedback	Alt. Finish Option
Control Unit/Feedback	Code		
None	Blank	←	←
Only available to be used with the following actuation codes: C, F, G, and H			
10-30VDC 12mm external prox, PNP, open/close, (qty 2), flying leads	01		
10-30 VDC 12mm external prox, NPN, open/close, (qty 2), flying leads	02		
10-30VDC 12mm external prox, PNP, open, (qty 1), flying leads	03		
10-30VDC 12mm external prox, PNP, close, (qty 1), flying leads	04		
10-30 VDC 12mm external prox, NPN, open, (qty 1), flying leads	05		
10-30VDC 12mm external prox, PNP, open/close, (qty 2), M12 quick disconnect	06		
10-30 VDC 12mm external prox, NPN, open/close, (qty 2), M12 quick disconnect	07		
10-30VDC 12mm external prox, PNP, open, (qty 1), M12 quick disconnect	08		
10-30VDC 12mm external prox, PNP, close, (qty 1), M12 quick disconnect	09		
10-30 VDC 12mm external prox, NPN, open, (qty 1), M12 quick disconnect	10		
Only available to be used with the following actuation codes: F, G, and H			
Burkert 8691, single acting, DeviceNet, multipin	11		
Burkert 8691, single acting, AS-I, multipin	12		
Burkert 8691, single acting, 24VDC, multipin	13		
Burkert 8691, double acting, DeviceNet, multipin	14		
Burkert 8691, double acting, AS-I, multipin	15		
Burkert 8691, double acting, 24VDC, multipin	16		
Burkert 8691, without solenoid, 24VDC, multipin	17		
Burkert 8692 positioner, 24VDC, 4-20mA, multipin	18		
Only available to be used with the following actuation codes: A, J, K, L, M, N, and P			
Limit switch box, open/close Beacon, (2) SPDT mechanical switches	19		
Limit switch box, open/close Beacon, (2) proximity SPDT switches	20		
Limit switch box, open/close Beacon, AS-I interface	21		
Only available to be used with the following actuation codes: J, K, L, M, N, and P			
Rotary pneumatic positioner 3-15 PSI input, no feedback	22		
Rotary pneumatic positioner 3-15 PSI input, (2) SPDT mechanical switches for feedback	23		
Rotary pneumatic positioner 3-15 PSI input, 4-20mA for feedback	24		
Rotary electropneumatic positioner 4-20mA input, no feedback	25		
Rotary electro-pneumatic positioner 4-20mA input, (2) SPDT mechanical switches for feedback	26		
Rotary electro-pneumatic positioner 4-20mA input, 4-20mA for feedback	27		
Rotary electro-pneumatic positioner 0-10v input, no feedback	28		
Rotary electro-pneumatic positioner 0-10v input, (2) SPDT mechanical switches for feedback	29		
Rotary electro-pneumatic positioner 0-10v input, 4-20mA for feedback	30		
Single coil solenoid, 12VDC	31		
Single coil solenoid, 24VDC	32		
Single coil solenoid, 24VAC	33		
Single coil solenoid, 110VAC	34		
Single coil solenoid, 220VAC	35		
Single coil solenoid, 12VDC + option 19 limit switch	36		
Single coil solenoid, 12VDC + option 20 limit switch	37		
Single coil solenoid, 24VDC + option 19 limit switch	38		
Single coil solenoid, 24VDC + option 20 limit switch	39		
Single coil solenoid, 24VAC + option 19 limit switch	40		
Single coil solenoid, 24VAC + option 20 limit switch	41		
Single coil solenoid, 110VAC + option 19 limit switch	42		
Single coil solenoid, 110VAC + option 20 limit switch	43		
Single coil solenoid, 220VAC + option 19 limit switch	44		
Single coil solenoid, 220VAC + option 20 limit switch	45		
Limit switch box with integral solenoid, AS-i, 24VDC	46		
Aluminium prox ring with red poly tube indicator	47		
Alternate Finish Option	Code		
None	Blank		
25Ra mechanical	B		
20Ra mechanical	C		
15Ra electropolish	D		

HSC Series Spring Check Valves

Application

- Spring check valves are designed to prevent reverse flow. The concentric design makes them ideal for vertical food and beverage applications.

Features

- Single-piece upper-body spider design
- Machined from solid bar
- Standard O-ring and gasket seal design
- Can be serviced in the field (no special tools required)
- Finish: sanitary polish 32Ra
- Suitable for low and medium-viscosity fluids
- Connection: clamp (standard), others available upon request

End Connections

- Weld, Triclover, SMS, DIN, and RJT ends are available

Maximum Operating Pressure

- 145 PSI at -9.4°C to 93°C

Maximum Operating Temperature

- 9°C to 93°C (15°F to 200°F)



HSC - Vertical Mount



EHSC - Horizontal Mount

Size		Part Numbers				Cracking Pressure (PSI)
		HSC - EPDM		EHSC - EPDM		
mm	inch	Clamp End	Weld End	Clamp End	Weld End	
12	½	HSCE050	HSCE050BB	EHSC050	EHSC050BB	10.0
20	¾	HSCE075	HSCE075BB	EHSC075	EHSC075BB	4.0
25	1	HSCE100	HSCE100BB	EHSC100	EHSC100BB	2.5
38	1½	HSCE150	HSCE150BB	EHSC150	EHSC150BB	1.0
50	2	HSCE200	HSCE200BB	EHSC200	EHSC200BB	1.5
65	2½	HSCE250	HSCE250BB	EHSC250	EHSC250BB	0.8
80	3	HSCE300	HSCE300BB	EHSC300	EHSC300BB	0.5
100	4	HSCE400	HSCE400BB	EHSC400	EHSC400BB	0.4

FKM available upon request

Product Group: VC10



Dimensions

Size		A (inch)
mm	inch	
12	½	2.7
20	¾	2.7
25	1	3.3
38	1½	3.4
50	2	3.4
65	2½	3.4
80	3	3.4
100	4	4.1



Kit Contains:

1/2" - 3/4" repair kit contains:

- (1) body gasket
- (1) plunger O-ring
- (1) spider O-ring

1" - 4" repair kit contains:

- (1) body gasket
- (1) plunger O-ring

Repair Kits

Size		Part Numbers
mm	inch	
12	½	HSC-RKE050
20	¾	HSC-RKE075
25	1	HSC-RKE100
38	1½	HSC-RKE150
50	2	HSC-RKE200
65	2½	HSC-RKE250
80	3	HSC-RKE300
100	4	HSC-RKE400

Product Group: VC10

Ball Valves - Encapsulated

Application

- Hygienic ball valve for food and chemical use with ISO mount plate.

Features

- Balanced encapsulated construction minimises cold flow
- Live-loaded stem packing
- Precision stainless steel balls reduce torque and friction losses while extending seat life
- A lockable handle can prevent accidental actuation
- Standard internal entry blow-out proof stem design
- Full-port design matches ball and seat ports to tube ID for lower pressure drop and less turbulent flow
- Compact design for areas with tight space restrictions

Materials

- PTFE seal
- CF8M 316 stainless steel
- ID polish is Ra 32 minimum
- Fully encapsulated construction produces bubble-tight seal
- Integral ISO 5211 mounting pad
- Optional seals available - 25% carbon-reinforced tetrafluoroethylene, 15% glass-reinforced RTFE, 50% stainless steel-reinforced PTFE, and UHMW

Size		Part Numbers	
mm	inch	Weld End	Clamp End
12	½	BV2CV-050BB-A	BV2CV-050CC-A
20	¾	BV2CV-075BB-A	BV2CV-075CC-A
25	1	BV2CV-100BB-A	BV2CV-100CC-A
38	1½	BV2CV-150BB-A	BV2CV-150CC-A
50	2	BV2CV-200BB-A	BV2CV-200CC-A
65	2½	BV2CV-250BB-A	BV2CV-250CC-A
80	3	BV2CV-300BB-A	BV2CV-300CC-A
100	4	BV2CV-400BB-A	BV2CV-400CC-A

Product Group: VS03



Clamp End

BV3/4 Series Multi-Port Sanitary Stainless Steel Ball Valves

Application

- Hygienic ball valve for food and chemical use with ISO mount plate.

Features

- Full-port design on ½" to 3"
- Reduced port design on 4"
- Blow-out proof stem
- Live-loaded stem packing
- ISO 5211 mounting pad
- Lock-out, tag-out

Materials

- Body, ends, and ball: CF8M stainless
- Seats: virgin PTFE, 15% glass reinforced RTFE, 25% carbon reinforced PTFE, 50% stainless steel reinforced PTFE or UHMW

Maximum Working Pressure

- ½" - 2" 1000 PSI WOG
- 4" 800 PSI WOG

Size		Part Numbers			
mm	inch	Weld End		Clamp End	
		T Port	L Port	T Port	L Port
12	½	BV3SVTF050B-A	BV3SVLF050B-A	BV3SVTF050C-A	BV3SVLF050C-A
20	¾	BV3SVTF075B-A	BV3SVLF075B-A	BV3SVTF075C-A	BV3SVLF075C-A
25	1	BV3SVTF100B-A	BV3SVLF100B-A	BV3SVTF100C-A	BV3SVLF100C-A
38	1½	BV3SVTF150B-A	BV3SVLF150B-A	BV3SVTF150C-A	BV3SVLF150C-A
50	2	BV3SVTF200B-A	BV3SVLF200B-A	BV3SVTF200C-A	BV3SVLF200C-A
65	2½	BV3SVTF250B-A	BV3SVLF250B-A	BV3SVTF250C-A	BV3SVLF250C-A
80	3	BV3SVTF300B-A	BV3SVLF300B-A	BV3SVTF300C-A	BV3SVLF300C-A
100	4	BV3SVTF400B-A	BV3SVLF400B-A	BV3SVTF400C-A	BV3SVLF400C-A

Product Group: VS03



Clamp End

BV3/4 Series Multi-Port Sanitary Stainless Steel Ball Valves

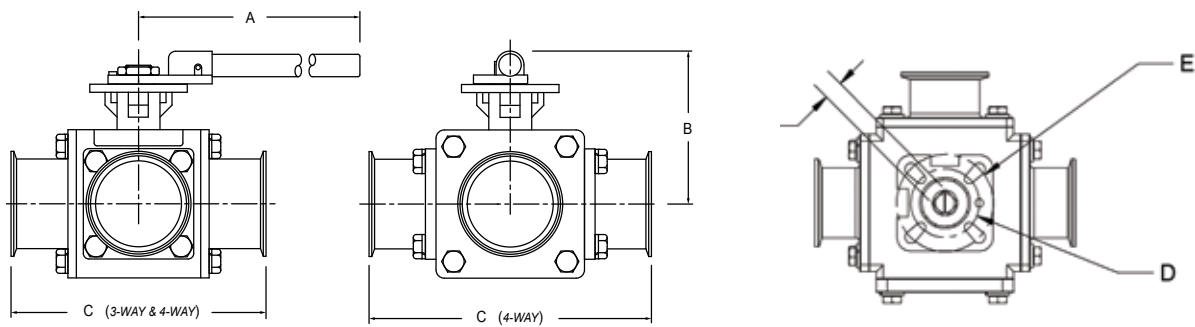

Size		A (mm)	B (mm)	C (mm)	D	E	F (mm)	Weight	L-Port Break Torque (in-lb)	T-Port Break Torque (in-lb)
mm	inch									
12	½	124.46	43.18	116.84	F03	F04	9.0	1.63	65	44
20	¾	127.00	48.25	127.00	F03	F04	9.0	1.95	76	76
25	1	134.62	58.42	152.40	F04	F05	11.0	3.08	171	171
38	1½	241.30	73.66	175.26	F05	F07	14.0	5.71	356	297
50	2	241.30	81.28	190.50	F05	F07	14.0	9.79	553	553
65	2½	457.20	99.06	213.36	F07	F10	17.0	15.26	1114	1114
80	3	464.82	124.46	243.84	F10	F12	22.0	25.58	1875	1400
100	4	464.82	137.16	289.56	F10	F12	22.0	38.73	2241	2050

4-way available upon request



Kit Contains:

- (2) encapsulated seat small
- (2) encapsulated seat large
- (2) body seals
- (1) thrust washer
- (1) O-ring
- (3) stem packings
- (1) plug (3-way only)

Repair Kits

Size		Part Numbers
mm	inch	
12	½	BV-3SVFRK050
20	¾	BV-3SVFRK075
25	1	BV-3SVFRK100
38	1½	BV-3SVFRK150
50	2	BV-3SVFRK200
65	2½	BV-3SVFRK250
80	3	BV-3SVFRK300
100	4	BV-3SVFRK400

Product Group: VS03

Flow Paths 3-Way L - Port

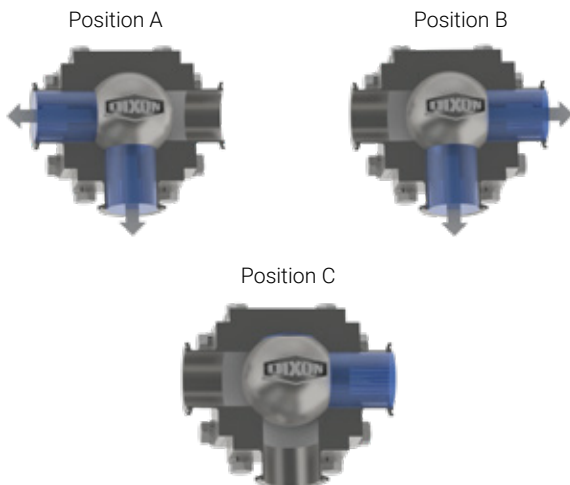

Flow Paths 3-Way T - Port

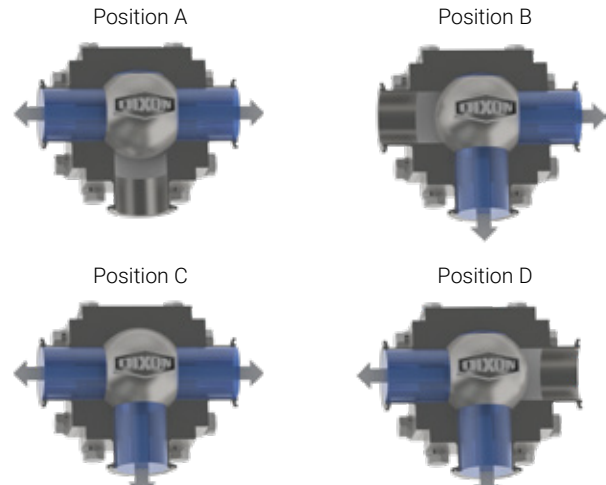

Air & Vacuum Relief Tank Vent Valve

Application

- The valve relieves pressure as the fluid level rises while filling a tank and relieves the vacuum as the fluid level drops while emptying a tank.

Features

- 50mm & 80mm (2" & 3") clamp connections on the same valve
- Dome helps in preventing external contamination
- Light-weight, robust PVC and 304 stainless steel construction
- Can use any clamp gasket

Materials

- 304 stainless steel
- PVC

Specifications

- Flow rate: 110m³/Hr
- Vacuum break: 0.1 PSI
- Pressure relief: 0.1 PSI

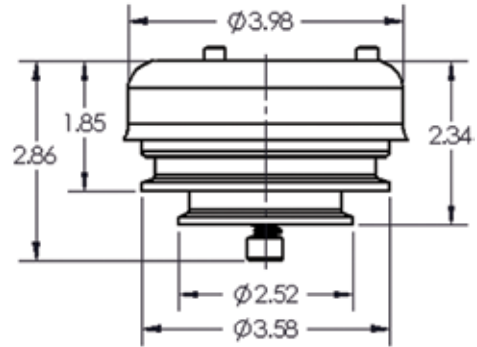

Size		Part Number
mm	inch	
50 & 80	2 & 3	TVPC200-300

Product Group: AV11



Air & Vacuum Relief Tank Vent Valve - Stainless Steel

Application

- The valve relieves pressure as the fluid level rises while filling a tank and relieves the vacuum as the fluid level drops while emptying a tank.

Features

- Seals under equal pressure
- A stainless steel screen surrounds the entire vacuum and pressure flow area
- ¼" FNPT connection for gas inlet, plugs also supplied

Materials

- 304 stainless steel
- EPDM elastomer

Specifications

- Vacuum break: 2" water column 0.1 PSI
- Pressure relief: 22" water column 0.8 PSI
- Maximum temperature & pressure rating: 3 PSI @ 21°C
- Tank fill & evacuation rate: 250 GPM max

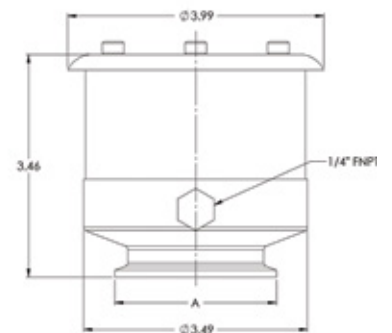
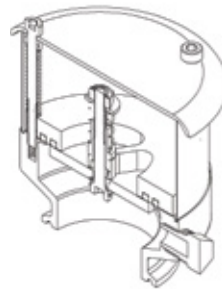

Size		Part Numbers	Dimension A (inch)
mm	inch		
50	2	TVSEC-G200	2.52
80	3	TVSEC-G300	3.58
100	4	TVSEC-G400	4.68

Product Group: AV11



- These valves have been designed as a secondary pressure and vacuum relief vent. Always open the upper manhole whenever the product is being transferred in excess of 250 gallons per minute

Application

- The Rieger aseptic mix-proof valve N7 ensures the reliable separation of process lines for liquid products by means of the SIP capable leakage space as well in-type "piping" as in-type "tank". CIP/SIP valves control the steam inlet and outlet in the leakage space.
- The outstanding aseptic properties are achieved by hermetic sealing from the environment. A temperature survey in the leakage chamber is available upon request. It is important to note, that the full spring force is applied as well in the rest position as when rinsing the valve.

Features

- Design: one-piece valve body, made from solid bar, short design, fewer welding seams, few seals in-product area
- Absolute product protection: safe media separation by leakage space, controlled leakage chamber, both valve disks are liftable separately
- Serviceable maintenance: change of seals without special tools, less standing time, easy cleaning
- Efficiency: long life of the PTFE bellows, low maintenance costs, with brackets for proximity switches on the main actuator

Materials

- In product contact: 1.4404/AISI316L
- Optional: 1.4435/AISI316L
- No product contact: 1.4301/AISI304
- Seals: bellows PTFE
- O-rings: EPDM

Product Contact Seals

- DIN 11850-R2 (DIN 11866 A)
- OD tube (DIN 11866 C)

Temperatures

- EPDM operating: 130°C dependent upon operating conditions.
- Sterilising: 150°C dependent upon operating conditions
- PTFE operating: 121°C short-time (approximately 20 minutes).
- Sterilising: 135°C short-time (approximately 20 minutes)

Operating Pressure

- Piping: maximum 6 bar
- Tank: maximum 4 bar
- Control air pressure: minimum 6 bar - maximum 4 bar

Surfaces

- In product contact: Ra ≤ 0.8 µm
- No product contact: Ra ≤ 1.6 µm

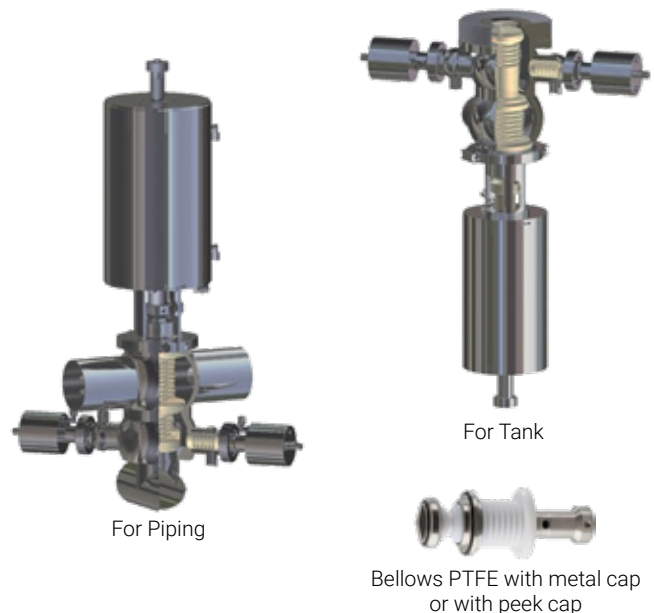

Dixon™/Rieger Aseptic Type Valves

Features

- Solid housing
- No dead spaces
- Fully drainable
- Many built-in positions are possible
- Complete separation from the environment
- No dome or sump in product space
- Change of seals without special tools
- Long-life PTFE bellows
- Low spare parts costs
- OD tube (DIN 11866 C)

Materials

- Product contact surfaces: 316L, 32Ra, optional surface finishes available
- No product contact: 1.4301/AISI304, 68Ra

Sizes

- 12mm to 100mm (½" to 4")

Specifications

- Maximum standard operating temperature: 121°C
- Sterilising temperature: 135°C
- Closure pressure: maximum 87 PSI (6 bar)
- Actuator air pressure: minimum 87 PSI (6 bar), maximum 145 PSI (10 bar)



SSV Series Single Seat Hygienic Valves

Application

- The SSV series single-seat valves offer a true hygienic design to meet your most demanding process applications. The SSV series valves are offered in 316L stainless steel with a variety of body configurations, seat, and stem seal materials to fit your specific needs. This valve series is designed to shut off or divert the flow in your process either remotely by using air or locally using a manual operating device. The rugged design of the actuator and valve body allows the valve to stand up to the harsh environments often found in the sanitary industry.

Features

- Options: manual, actuated (spring return, double acting), control tops
- Surface finish: <32Ra standard
- Air connections: 1/8" FNPT

Materials

- Body: 316L stainless steel
- Actuator: 304 stainless steel
- Manual operating device: 304 stainless steel
- Stem seal: Nitrile Buna, EPDM, FKM
- Seat seal: Nitrile Buna, EPDM, FKM, PTFE

Temperatures

- Temperature range: -45°C to 100°C (-50°F to 212°F)

Sizes

- 25mm to 100mm (1" to 4")

Refer to page 17 for the part number key table



Positioner Type 8692 & 8694 - For Pneumatic Control Angle Valves

Application

- Digital electro-pneumatic positioner for the integrated mounting on process control valves.

Features

- Compact stainless steel design
- Graphic display with backlight
- Easy start-up
- A comprehensive range of additional software functions
- Internal control air channel

Size		Part Numbers
mm	inch	
25 - 38	1 - 1½	CV-AK100-150
50 - 100	2 - 4	CV-AK200-4000

Product Group: VF10



SSV Single Seat Valve Part Number Key

Example:

Part Number - D06B20NBCCC2PVG

Part Description: Divert Valve, T/L Body, 25Ra Polish, 2", [No Port on A, Buttsweld on Port B, Clamp Port C, Clamp on Port D, Clamp on Port E Spring Return Air-to-Lower Actuator, PTFE Stem Seal, FKM wetted Elastomers, Burkert 8691 Single Acting 24VDC Multipin.

Diagram A (Body Styles)

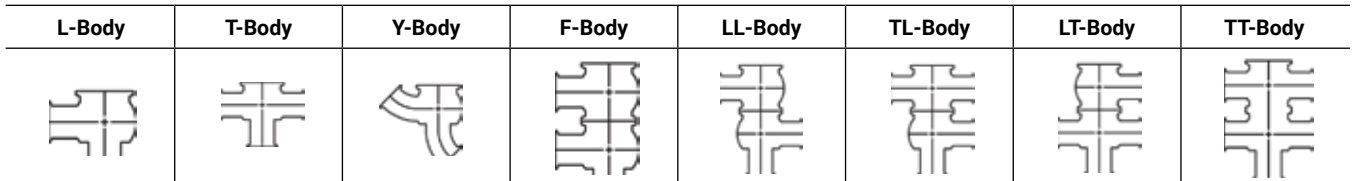

Dixon SSV-Series Single Seat Valve Part Number Key		Valve Function	Valve Body			Actuator Function	Stem Type	Wetted Elastomers	Options	
		S	01	A	10	C	1	E	E	A
Valve Function	Code									
Shut-Off	S	←								
Divert	D									
Valve Body Style (See Diagram A)	Code									
L (2-port Shut-Off)	01		←							
T (3-port Shut-Off)	02			←						
Y (2-port Shut-Off)	03				←					
F (3-port Divert)	04					←				
L/L (3-port Divert)	05						←			
T/L (4-port Divert)	06							←		
L/T (4-port Divert)	07								←	
T/T (5-port Divert)	08									←
Surface Finish	Code									
32 Ra (ID Mech. Polish)	A								←	
25 Ra (ID Mech. Polish)	B									←
20 Ra (ID Mech. Polish)	C									←
15 Ra (ID Electropolish)	D									←
Valve Size	Code									
1"	10									←
1½"	15									←
2"	20									←
2½"	25									←
3"	30									←
4"	40									←
Connections	Code									
Triclamp	C									←
Buttweld	B									←
Female I-Line	F									←
Male I-Line	M									←
Threaded Bevel	T									←
Plain Bevel	P									←
Q-Line	Q									←
Combination (See Table 1)	—									←
Actuator Type	Code									
Pneumatic Spring Return (Air-to-Raise)	1									←
Pneumatic Spring Return (Air-to-Lower)	2									←
Pneumatic Double Acting (Air-to-Air)	3									←
Manual Handle	4									←
Stem Type	Code									
Elastomer O-Ring Stem Seal	E									←
PTFE Plug Seal	P									←
Wetted Elastomers	Code									
EPDM	E									←
FKM	V									←

Options		Code
10-30VDC External Prox, PNP, (Qty 2)		A
10-30 VDC External Prox, NPN, (Qty 2)		B
20-253 VAC External Prox, (Qty 2)		C
110VAC External Prox, (Qty 2)		D
Burkert 8691, Single Acting, DeviceNet, Multipin		E
Burkert 8691, Single Acting, AS-i, Multipin		F
Burkert 8691, Single Acting, 24VDC, Multipin		G
Burkert 8691, Double Acting, DeviceNet, Multipin		H
Burkert 8691, Double Acting, AS-i, Multipin		J
Burkert 8691, Double Acting, 24VDC, Multipin		K
Burkert 8691, Without Solenoid, 24VDC, Multipin		L
Burkert 8681, Single Acting, 110VAC, Multipin		M
Burkert 8681, Double Acting, 110VAC, Multipin		N
Burkert 8692 Positioner, 24VDC, 4-20mA, Multipin		P
External Prox Bracket Only		Q

A-Port	B-Port	C-Port	D-Port	E-Port	Port Diagram
C	C	C	C	C	
B	B	B	B	B	
F	F	F	F	F	
M	M	M	M	M	
T	T	T	T	T	
P	P	P	P	P	
Q	Q	Q	Q	Q	
N (No Port)	---	N (No Port)	N (No Port)	N (No Port)	

Dixon™/Rieger Mix Proof Valves



Application

- Dixon™/Rieger Mix Proof valves ensure reliable protection of your product, separating non-compatible liquids. The design of the one-part solid valve body and the radial sealing of both valve seats together with the balanced valve disks allows safe CIP/SIP cleaning thus providing high safety for your products.

Features

- One-piece valve body made from solid bar
- No weld torsion
- Water-hammer safe up to 435 PSI (30 bar)
- Balanced valve disks
- Low need for controlled air
- Lightweight - 100mm (4"), 35kg
- Standard actuator with 3 lift functions
- Easy cleaning by lifting off both disks
- Service without compressed air
- Valve insert removable upwards
- Radial sealing of both valve seats
- Only 4 seals in the product space
- Change seals without special tools
- 316L stainless steel in contact with the product
- Inner surface Ra 0.8 µm (standard)

Options

- Mix proof bottom seat valve
- Mix proof bottom seat change over valve
- Mix proof change over valve

Sizes

- 25mm to 150mm (1" to 6")

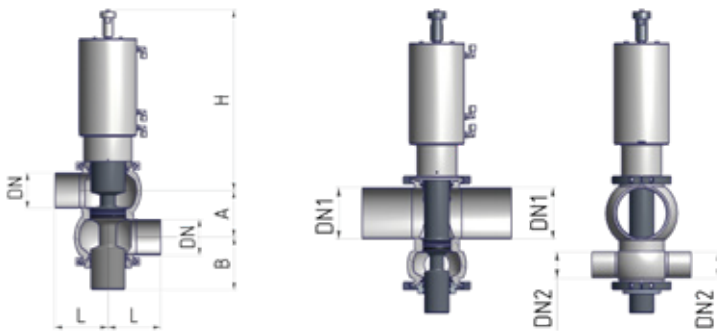

Different sizes on the upper to the lower process line are also available

Valve Body Types

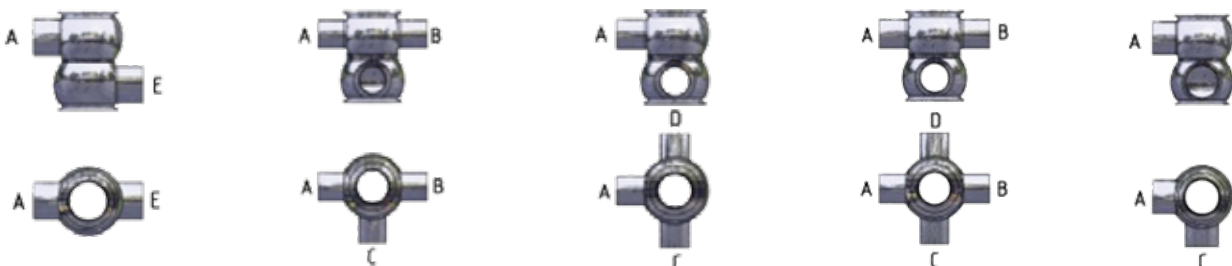

Application

- The process control head is fitted for the controlling of pneumatically operated process valves. The design of the valve body eliminates dead space, a prerequisite for sterile process engineering. When working with high sterilisation temperatures this valve fulfils demands for operational security and reliable function. Used in dairies, food & beverage, pharmaceutical, and chemical industries.

Features

- Valve body made from solid bar
- No dead spaces
- Drainable when mounted in various positions
- High-grade inner surfaces
- No dome or sump in product space
- Change of seals without special tools
- Optimum cleanability
- Modular assembly system
- Low spare part costs
- Complete separation from the environment

Materials

- Product wetted: 1.4404/AISI316L
- Optional: 1.4435/AISI316L
- No product contact: 1.4301/AISI304

Temperatures

Control Valve

- Maximum standard operating temperature: 130°C
- Sterilisation temperature: 150°C short time (approx. 20 mins) dependent upon operating conditions

Aseptic Version

- Maximum temperature: 121°C
- Sterilisation Temperature: 135°C short time (approx. 20 mins) dependent upon operating conditions

Surfaces

- Wetted product surfaces: Ra <= 0.8 µm (32), optional surfaces available
- No product contact: Ra <= 1.6 µm

Product Contact Seals

Control Valve

- O-rings & profile washer: EPDM (other materials upon request)

Aseptic Version

- Seals: bellows PTFE

Standard Operating Pressures

- Standard pressure: maximum 6 bar (87 PSI)
- Actuator air pressure: minimum 6 bar (87 PSI) - maximum 10 bar (145 PSI)
- Controlled air pressure: maximum 10 bar (145 PSI)

Product Contact Seals

- OD - tube (DIN 11866 C) weld optional connections on request



Mini Aseptic Sampling Valve



Application

- The Mini BioCheck sampling valves meet the requirement for minimal product contact surfaces. The mini valves allow minimal sampling quantities fulfilling the same valve features in material and design compared to the larger valves such as DN 10 (½").

Options

- Pipe, vessel, clamp connection (25mm or 34mm)
- 1 port for sampling
- 2 ports for CIP and/or SIP plus sampling
- DIN 6 (8 x 1mm pipe)
- DIN 8 (10 x 1mm pipe)
- Hand wheel
- Pneumatic (spring to close)
- Pneumatic and lever

Part Numbers	Description
BCSV-11632	Rieger biocheck sampling valve DN6 sanitary 25.4 NC PTFE AISI316L 2 x BW weld points
BCSV-RK	Biocheck sampling valve service kit 1 x O-Ring silicon 1 x PTFE bellows Product Group: VF10



BioCheck Combi Sampling Valves with Steam Valve

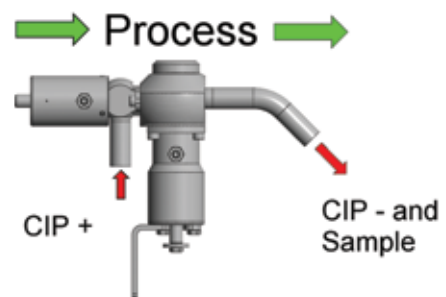
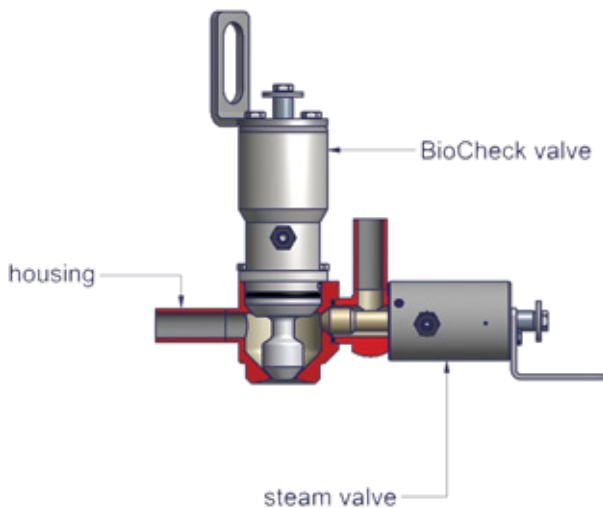

Part Number	Description
BCCV-73601	Biocheck combi sampling valve DN10 for tank NC PTFE/PEEK/AISI 316L Product Group: VF10

Application

- The 3A sample valve allows easy and safe sampling of liquids from closed systems such as vessels and pipelines. These valves are located in the pharmaceutical, bio-pharmaceutical, biochemical, cosmetic, food, dairy, and beverage markets.

Features

- No dead spaces
- Drainable
- Connections suitable for orbital welding
- Available with single or dual ports
- Hermetically sealed against the environment
- Optimum cleanability
- Change of seals without special tools
- Long life of the PTFE bellows
- Options for Pneumatic Actuator: no lever, with self-closing lever and with lever for open position
- Manual actuator (hand wheel)
- Optional pneumatic actuator
- Tank weld and tube weld options available on request

Materials

- Product contact surfaces: 316L, 0.8µm Ra, optional surface finishes available
- No product contact: 304, 1.6µm Ra
- Product contact seals: PTFE bellows

Specifications

- Closaessure: maximum 116 PSI
- Hand wheel version operating pressure: minimum 87 PSI, maximum 232 PSI
- Controlled air pressure: maximum 145 PSI

Sizes

- 12mm to 100mm (½" to 4")



Single Port Actuated



Single Port



Dual Port

Clamp Valve Size		Weld Port Size		Part Numbers	
mm	inch	mm	inch	Single Port	Dual Port
12	½	6	¼	BSVS-HC050B025	BSVD-HC050B025
		10	⅜	BSVS-HC050B375	BSVD-HC050B375
		12	½	BSVS-HC050B050	BSVD-HC050B050
25	1	6	¼	BSVS-HC100B025	BSVD-HC100B025
		10	⅜	BSVS-HC100B375	BSVD-HC100B375
		12	½	BSVS-HC100B050	BSVD-HC100B050
38	1½	6	¼	BSVS-HC150B025	BSVD-HC150B025
		10	⅜	BSVS-HC150B375	BSVD-HC150B375
		12	½	BSVS-HC150B050	BSVD-HC150B050
50	2	6	¼	BSVS-HC200B025	BSVD-HC200B025
		10	⅜	BSVS-HC200B375	BSVD-HC200B375
		12	½	BSVS-HC200B050	BSVD-HC200B050
65	2½	6	¼	BSVS-HC250B025	BSVD-HC250B025
		10	⅜	BSVS-HC250B375	BSVD-HC250B375
		12	½	BSVS-HC250B050	BSVD-HC250B050
80	3	6	¼	BSVS-HC300B025	BSVD-HC300B025
		10	⅜	BSVS-HC300B375	BSVD-HC300B375
		12	½	BSVS-HC300B050	BSVD-HC300B050
100	4	6	¼	BSVS-HC400B025	BSVD-HC400B025
		10	⅜	BSVS-HC400B375	BSVD-HC400B375
		12	½	BSVS-HC400B050	BSVD-HC400B050

Product Group: VF10

Application

- The safety valve prevents excess pressure of gaseous media in pipelines and vessels. The set pressure is always higher than the operating pressure. As soon as the pressure is reached, the valve opens against the force of the spring. The pressure excess is relieved as soon as the pressure is 10% higher than the set pressure.

Features

- The valve body is made from solid bar
- No dead spaces
- Drainable
- Connections suitable for orbital welding
- High-grade inner surfaces
- Change of seals without special tools
- Optimum cleanability
- No sump, no dome
- Low spare part costs
- Safety: closed spring cap
- Modular assembly systems
- Adjustable set pressure
- Passed the EC type examination (module B) according to directive 97/23/EG for steam and gas for the set ranges from 22 PSI to 116 PSI, for 25mm & 38mm (1" & 1½") from 29 PSI to 116 PSI
- 3A versions not available

Materials

- Product contact: 1.4404/AISI316L
- Optional: 1.4435/AISI316L
- No product contact: 1.4301/AISI304

Temperatures

- Maximum standard operating temperature: 130°C
- Sterilisation temperature: 150°C short time (approx. 20 mins)

Surfaces

- Wetted product surfaces: Ra <= 0.8 µm (32)
- No product contact: Ra <= 1.6 µm

Product Contact Seals

- O-rings: EPDM or FKM

Pressure

- Set pressure: 22 PSI to 116 PSI resp. 29 PSI to 116 PSI
- Controlled air pressure: min. 87 PSI max. 145 PSI

Connections

- Weld ends combined with concentricity reduced inch clamp ferrules



SOV Series Manual & Pneumatic Overflow Valve

Application

- Precise control and unparalleled safety with our versatile, dual-operation valves that open when the set pressure is reached, preventing excess pressure in piping or systems. Suitable for liquids, steam, and gas.

Features

- The valve body is made from solid bar
- No dead spaces
- Drainable when mounted in various positions
- High-grade inner surfaces
- Change of seals without special tools
- No sump, no dome
- Clamp union between the valve body and actuator
- Modular assembly system - easy change between hygienic and aseptic type
- Standard seals
- OD tube (DIN 11866 C)

Materials

- Product contact surfaces: 316L, 32Ra
- No product contact: 1.4301/AISI304
- Hygienic EPDM O-rings
- Aseptic PTFE bellows

Sizes

- 25mm to 80mm (1" to 3")

Specifications

- Maximum standard operating temperature EPDM: 130°C
- Maximum standard operating temperature PTFE: 121°C
- Sterilisation temperature EPDM: 149°C
- Sterilisation temperature PTFE: 135°C
- Possible set pressure for O-ring version: 8 PSI to 87 PSI, 22 PSI to 87 PSI
- PTFE bellows version pressure range depends on spring control air pressure: min. 87 PSI, max. 145 PSI



SPR Series Pressure Relief Valves

Application

- Experience unparalleled safety and reliability with our advanced, adjustable relief valves. Designed for diverse applications, these compact valves ensure system protection and stability. The SPR Series Pressure Relief Valves cater to a wide range of markets and industries, including but not limited to chemical processing, pharmaceuticals, water treatment, food and beverage, oil and gas, power generation, and HVAC systems.

Features

- The valve opens when the set pressure is reached to prevent excess pressure in piping or systems
- The valve body is made from solid bar
- Patented squeeze clamp
- Low spare part cost
- Various pressure ranges
- Standard connections clamp, others available on request

Materials

- Product contact surfaces: 316L, 32Ra, other surface finishes available
- No product contact: 304
- Product contact O-ring: EPDM or FKM

Specifications

- Actuation: manual
- Maximum standard operating temperature: 130°C
- Sterilisation temperature EPDM: 149°C
- Pressure ranges: 0-50 PSI, 50-100 PSI, 100-300 PSI



Size		Part Numbers	Body Style	Spring Set PSI Range
mm	inch			
38	1½	SPR-TCE1A150	T-Body	0-50
		SPR-TCE2A150		50-100
		SPR-TCE3A150		100-300
		SPR-LCE1A150	L-Body	0-50
		SPR-LCE2A150		50-100
		SPR-LCE3A150		100-300
50	2	SPR-TCE1A200	T-Body	0-50
		SPR-TCE2A200		50-100
		SPR-TCE3A200		100-300
		SPR-LCE1A200	L-Body	0-50
		SPR-LCE2A200		50-100
		SPR-LCE3A200		100-300

EPDM is standard. FKM available upon request.

Product Group: VF11

JZW Series Heli-Lobe Wine Pump

Application

- Enhance your wine-making process with our gentle, efficient, and hygienic pumping solution. Designed specifically for the wine industry, our innovative pump ensures optimal product integrity and quality where gentle treatment and pulsation-free pumping are required.

Features

- Heli-lobe rotors standard
- Stainless steel gearbox
- Lobes are rubber coated and therefore safe from galling from grape skins, seeds, and stems
- Front loading seal options:
 - TC vs TC
 - Single and double O-ring seals
 - Triple lip seal
 - Flush option available on all seal types
- Elastomers:
 - EPDM (standard) and FKM
- Rotors:
 - Heli-lobe rotors standard
- Connections:
 - Triclamp (standard), all others available
- Options:
 - Front cover pressure relief valve



Model	Liters/100 REV	Bar	Port Size (inch)	Maximum Speed RPM
ZW120	113.56	4	2	1000

Contact Dixon™ for Pump Trolley Configurations

RZL Series Rotary Lobe Pumps

Application

- Movement of products that are viscous or contain solids or where gentle treatment of a product is required. Used in food processing, dairy, pharmaceutical, beverage, brewing, wine, and personal care.

Features

- All wetted parts are 316L stainless steel
- Front loading seal options:
 - Single (standard) and double mechanical seals, TC vs. TC (standard)
 - Single and double O-ring seals
 - Triple lip seal
 - Flush option available on all seal types
- Rotors:
 - Bi-wing (standard)
 - Single wing
 - Bi-lobe
 - Tri-lobe
 - Multi-lobe
 - Heli-lobe
 - Spur gear
- Connections:
 - Clamp (standard), others available upon request



Model	Liters/100 REV	Bar	Port Size (inch)	Maximum Speed RPM
RZL105	2.00	20	1	1000
RZL110	4.99	20	1	1000
RZL115	11.99	12	1½	800
RZL120	20.97	8	2	800
RZL220	40.92	12	2	700
RZL225	61.89	8	2½	700
RZL330	101.82	12	3	600
RZL340	143.76	8	4	600
RZL440	226.67	12	4	500
RZL450	333.49	8	5	500



Heli-Lobe Rotors

Features

- Pulsation-free heli-lobe rotors give the pump increased capacity through higher speed limits and increased suction capability through decreasing cavitation limits
- Double and triple heli-lobe rotors with front bearing covers are designed to pump up to 1097 litres/100 REV up to a maximum 30 bar



RZL Series Rotary Lobe Pump Options



Thermal Jacket Pumps

Designed for products that require temperature control such as sugars, chocolate, corn syrup, and brewer's yeast with easy attachment to pump front cover and/or casing



Rectangular Inlet

An enlarged rectangular inlet allows highly viscous products such as semi-solid pastes or mixtures containing semi-solid pieces to be pumped



Pressure Relief Valve

The pressure relief valve protects the system from pressure peaks or restrictions in the discharge, providing a pressure relief valve loop from discharge to the suction areas up to 10 bar



Ultra Clean Pumps

The fully self-draining pump head and external rotor fixing can eliminate any contaminations and internal crevices. Excellent for sterile pharmaceuticals, ultra-hygienic food processing, and aseptic manufacturing. Available in all sizes



High Pressure Pumps

High-pressure pumps have a front bearing cover to support shafts on front and back position. The well-balanced shaft design can handle pressures up to 30 bar without shaft deflection



Acculab

Specially designed for superior metering accuracy with multi-lobe rotors or spur gear rotors which allow minimum pulsation, precise volumetric dosing, and packaging, lab and pilot plants or manufacturing applications as well as general fluid transfer

RZP Series Circumferential Piston Pumps

Application

- The pump can be fitted with a variety of features and options to ensure the best performance will be achieved for your specific application. Food processing, dairy, beverage, pharmaceutical, personal care, and industrial markets.

Features

- All wetted parts are 316L stainless steel
- Front loading seal options:
 - Single (standard) and double mechanical seals, TC vs. TC (standard)
 - Single and double O-ring seals
 - Triple lip seal
 - Flush option available on all seal types
- Elastomers:
 - EPDM (standard) and FKM
- Rotors:
 - 316L bi-wing (standard)
- Connections:
 - Clamp (standard), others available upon request
- Options:
 - Rectangular inlet
 - Thermal heating jackets
 - Pressure relief valve cover
 - Universal series dimension base



Model	Liters/100 REV	Bar	Port Size (inch)	Maximum Speed RPM
RZP015	5.22	10	1½	800
RZP030	25.96	14	2	700
RZP060	73.96	17	2½	600
RZP130	117.99	10	3	600

ExD Series Sanitary Centrifugal Pumps

Application

- Used for high-efficiency non-viscous fluid transfer, bottling, and general transfer.

Features

- Available in 4 sizes
- Pump casing and front cover precision machined from solid bar
- Modular 2-piece adapter with interchangeable Nema motor flanges slotted adapter allows casing outlet to be rotated from 90° to 180° degrees without disassembly
- Modular stub shaft design with interchangeable Nema motor shaft sleeves
- Unique stub shaft leak chamber allows for immediate external identification of seal wear
- Mechanical seal components are inter-changeable with BC-series seals
- Compact and maintenance-friendly adapter guard set
- Efficient semi-open impeller design
- Seal type: single mechanical
- Finish: sanitary polish 0.8µm Ra
- Pump casing machined with external flats for easy casing drain addition
- Connections: clamp (standard)
- Nominal capacity: up to 113M³/hr
- Maximum head: 68m
- Nominal speed: up to 3000 RPM - 50Hz

Specifications

- Temperature: 0 to 100
- Motor: standard B5 face, 3000 RPM - 1500Hz
- Mounting: wet end mounted to a C-face motor
- Mounting options: adjustable legs or pump cart

Materials

- Product contact: 316L stainless steel and fully traceable
- No product contact: 304 stainless steel
- Stationary seal seat material: silicon carbide, ceramic, or tungsten carbide
- Rotary seal material: carbon or silicon carbide
- Elastomers: Nitrile Buna, EPDM, silicone, or FKM
- Optional leg kit: 304 stainless steel



JCP Series Centrifugal Pumps

Application

- Used for high-efficiency non-viscous fluid transfer, bottling, and general transfer.

Features

- All wetted parts are 316L-resistant stainless steel
- Totally cleanable CIP and SIP, meets EHEDG and 3A standard
- One size shaft seal for all pump sizes
- Unique front loading seal, no need to disconnect process pipework
- Single seal to flushed seal within minutes with just a few extra parts

- Elastomers:
 - EPDM (standard), FKM, and Kalrez®
- Connections:
 - RJT, clamp, and others available upon request
- Flows up to 100m³/hr and heads up to 100m
- Individual curves available



Performance Curves

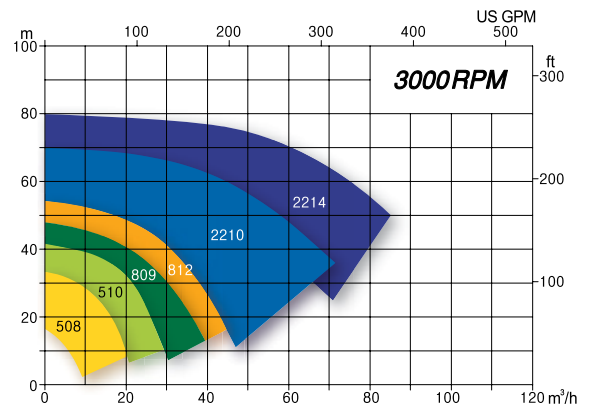

BC Series Centrifugal Pumps

Application

- General duty non-viscous fluid transfer, wide open impeller also allows for some solids. Ideal winery pump that can also double for transfer.

Features

- Volute: 316L stainless steel
- Impeller: CF3M (316L) stainless steel
- Backplate: 316L stainless steel
- Stub Shaft: 316L stainless steel
- Adaptor: 304 stainless steel

- Optional Leg Kit: 304 stainless steel
- Seal Types: externally balanced DG with clamped-in seat
- Elastomers: Nitrile Buna, EPDM, silicone, and FKM
- Finish: sanitary polish 0.8µm Ra



Specifications

- Nominal capacity: up to 177m³/hr
- Temperature: 0°C to 100°C
- Nominal speed: up to 3000RPM - 50 Hz

Motors and Mounting

- Motor: standard B35 flange washdown, foot-mounted
- Additional motor types available upon request
- Mounting: pump head mounted to a B35 face motor

Family of Curves

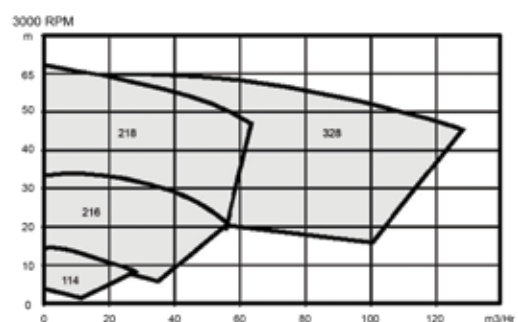
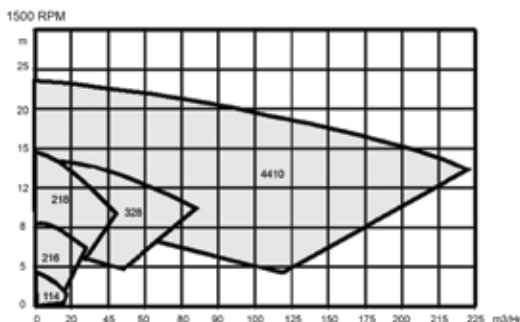

JWP Series - Water for Injection

Application

- JWP series pumps are ideal for high purity, pyrogen free fluid for pharmaceutical processes, and deionised water.

Features

- All internal surfaces are finished to 0.4µm Ra with electro-polish optional
- Fully drainable and cleanable for CIP and SIP so as to meet EHEDG and 3A standards
- The housing, cover, and impeller are investment cast and then precision machined
- Elastomers:
 - EPDM (standard), FKM, and Kalrez®
- Connections:
 - RJT, clamp, and others available upon request

- Options:
 - Several piping configurations optional. Auxillary flow control devices, including flow meter, thermometer, and check valve
- Flows up to 100m³/hr and heads up to 100m
- Individual curves available

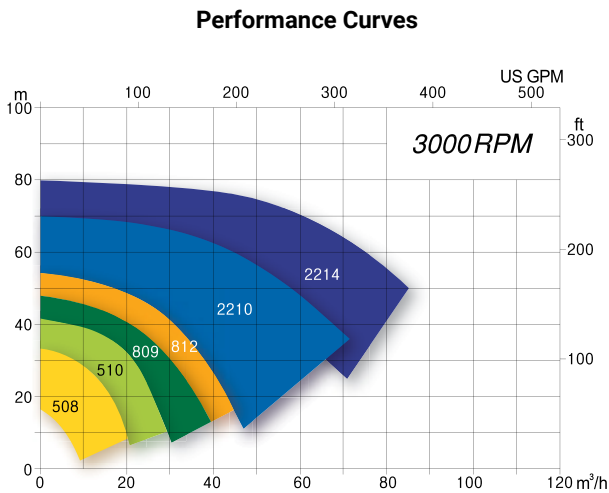

JEPS Series Self-Priming Centrifugal Pump

Application

- JEPS self-priming pumps are designed specifically for products containing air and gas that cannot be pumped by general centrifugal pumps.

Features

- Special airscrew generates a self-priming effect and optimises pump operation
- Lower noise levels and better power consumption than liquid ring pumps
- Housing, cover, and impeller are investment cast and then precision machined
- Elastomers:
 - EPDM (standard), FKM, and Kalrez®

- Connections:
 - RJT, clamp, and others available upon request
- Individual curves available

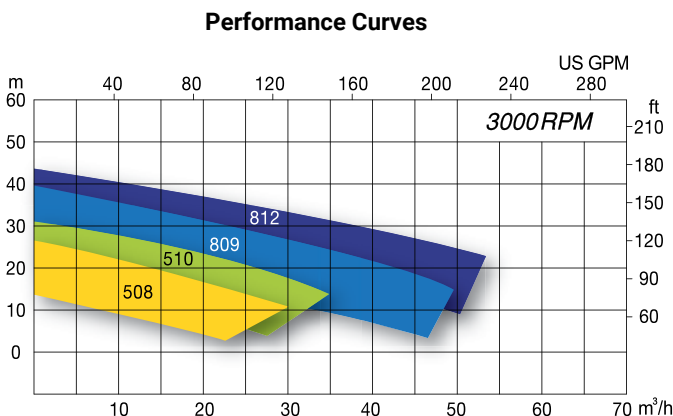

JSB Series Shear Blender

Application

- Designed to blend, emulsify, disperse, dissolve, and homogenise.

Features

- Supremely efficient and rapid in operation. Can shorten the processing time by up to 90% when compared to conventional agitators or paddles
- All wetted parts are AISI 316 stainless steel
- Fully CIP capable
- Field changeable to standard JCP centrifugal pump with impeller change
- Elastomers:
 - EPDM (standard), FKM, and Kalrez®
- Connections:
 - RJT, clamp, and others available upon request
- Capacities up to 80m³/hr



Performance Curves

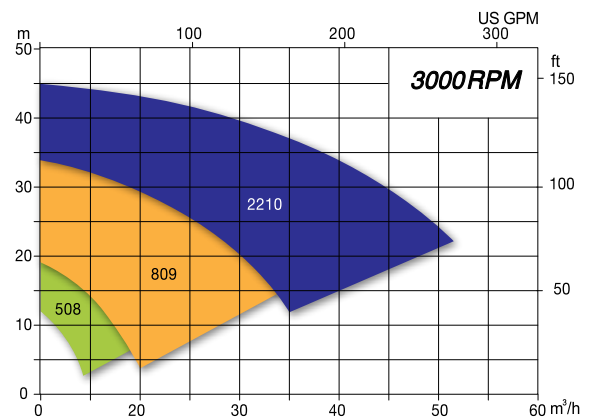

MB100 Series Centrifugal Pump

Engineered for hygienic performance in food, beverage, dairy, winery, and brewery applications.





The Right Connection®

Dixon (Asia Pacific) Pty Ltd

170 Francis Road
Wingfield SA 5013

1300 134 651

dixonvalve.com.au

South Australia, Adelaide

(Head Office)
170 Francis Road
Wingfield SA 5013

Queensland, Brisbane

6 Union Circuit
Yatala QLD 4207

Queensland, Mackay

38 John Vella Drive
Paget QLD 4740

Victoria, Melbourne

13 Commercial Drive
Dandenong VIC 3175

Western Australia, Perth

19 Baile Road
Canning Vale WA 6155

New South Wales, Sydney

15 Watsford Road
Campbelltown NSW 2560