

## Spray Balls

<b>Application:</b>	Typical use is in food and beverage industries for cleaning storage tanks.
<b>Features:</b>	Heavy stainless steel construction provides longer life. Various spray patterns available (blanks available as special order). Stationary - designed to be mounted to a tube or pipe. 2mm spray holes
<b>Material:</b>	316L stainless steel

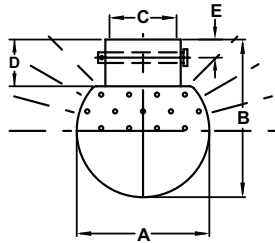

180° Top Pattern

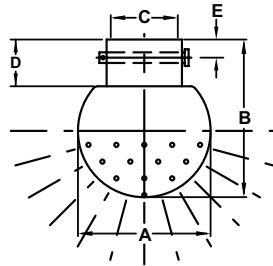

180° Bottom Pattern

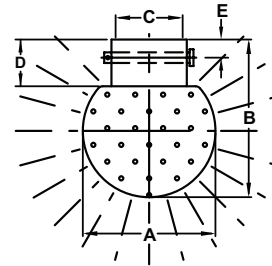

360° Pattern

### Stationary Spray Balls - STC

Size (inch)	Pin Length	Spray Pattern	Dimensions					Pin Size	Part No.	Price \$
			A	B	C	D	E			
1	1.47	360°	90	75	25	25	11	5.7	STC-360-R100	175.01
1½	1.95	360°	90	75	38	25	11	5.7	STC-360-R150	269.95
1	1.47	180° bottom	90	75	25	25	11	5.7	STC-180B-R100	178.12
1½	1.95	180° bottom	90	75	38	25	11	5.7	STC-180B-R150	254.46
1	1.47	180° top	90	75	25	25	11	5.7	STC-180T-R100	178.12
1½	1.95	180° top	90	75	38	25	11	5.7	STC-180T-R150	254.46



Price Group: DS

AV08

