



The Right Connection™

SIZE: 1/4" - 2"

2-PC BALL VALVE, FULL BORE, THREADED END, 1000 WOG

# SP2PBSPMF

1000PSI

- ◆ Full Port
- ◆ Investment Casting
- ◆ Blow-out proof Stem
- ◆ Locking Device Handle(option)
- ◆ PED97/23/PE (CE0035) Approved
- ◆ Casting Approved AD2000-WO
- ◆ Thread: ASME B1.20.1 BS21.DIN2999/259, ISO228-1, JIS B 0203, IS07/1
- ◆ Inspection Testing: API1598, EN12266

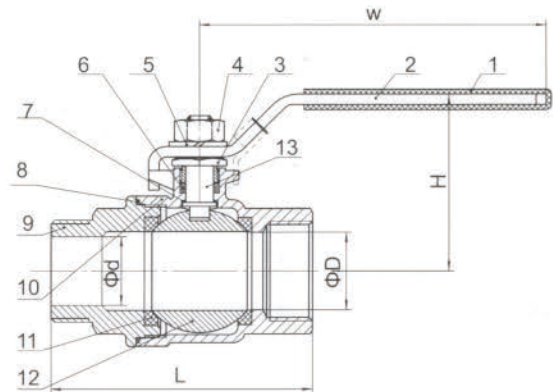
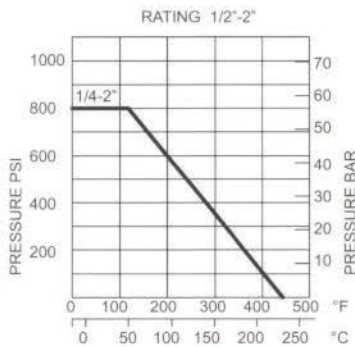

ITEM	DESIGNATION	QTY	MATERIAL
1	HANDLE SLEEVE	1	PVC
2	HANDLE	1	304
3	GLAND NUT	1	304
4	STEM NUT	1	304
5	SPRING WASHER	1	304
6	STEM PACKING	1	PTFE
7	THRUST WASHER	1	PTFE
8	JOINT GASKET	1	PTFE
9	CAP	1	CF8/CF8M
10	BODY	1	CF8/CF8M
11	BALL SEAT	2	RPTFE
12	BALL	1	CF8/CF8M
13	STEM	1	304/316

SIZE	D	d	L	H	W	S
1/4"	11.6	8	55	48	91	19
3/8"	12.5	11.4	55	48	91	21
1/2"	15	13.6	71.5	52	91	25.5
3/4"	20	18.2	78	61	111	31
1"	25	23	91	65	111	37.5
1-1/4"	32	32	100	79	154	46.5
1-1/2"	38	38	112	83	154	53.5
2"	50	48	142	97	192	66